

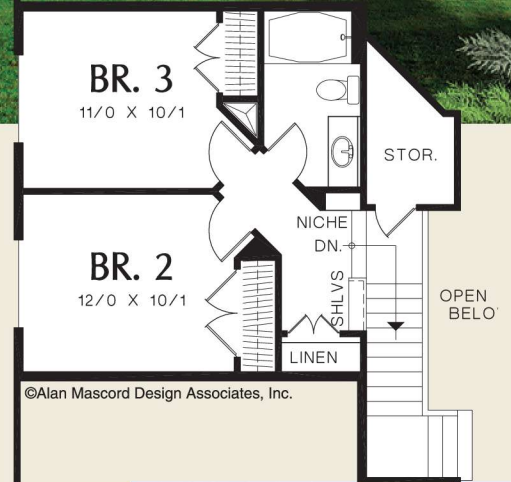

©Alan Mascord Design Associates, Inc.



©Alan Mascord Design Associates, Inc.



©Alan Mascord Design Associates, Inc.



Upper Floor	430 Sq. Ft
Main Floor	1514 Sq. Ft
Total Area	1944 Sq. Ft

Width 45'-0" **Depth** 55'-0"

Height (Main Flr to Peak): 26'-8"
(to Midpt of Roof): 17'-8"



ALAN MASCORD DESIGN ASSOCIATES, INC
2187 NW Reed St, Suite 100, Portland, OR 97210 · 503.225.9161

mascord.com | houseplans.co