

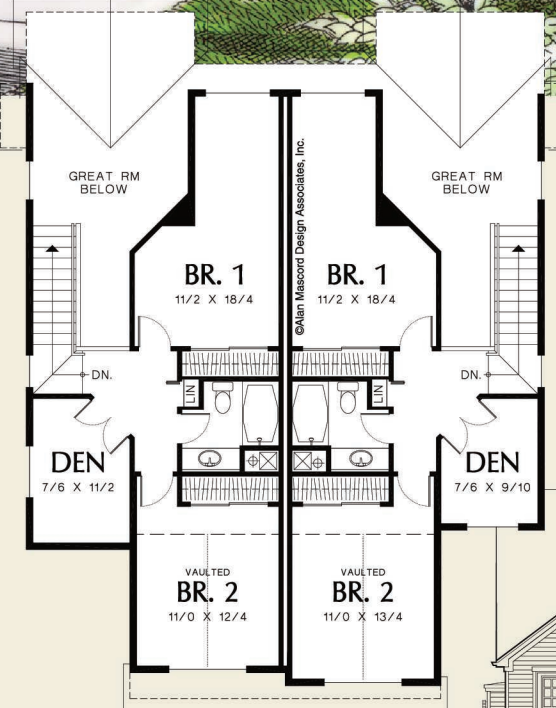

©Alan Mascord Design Associates, Inc.

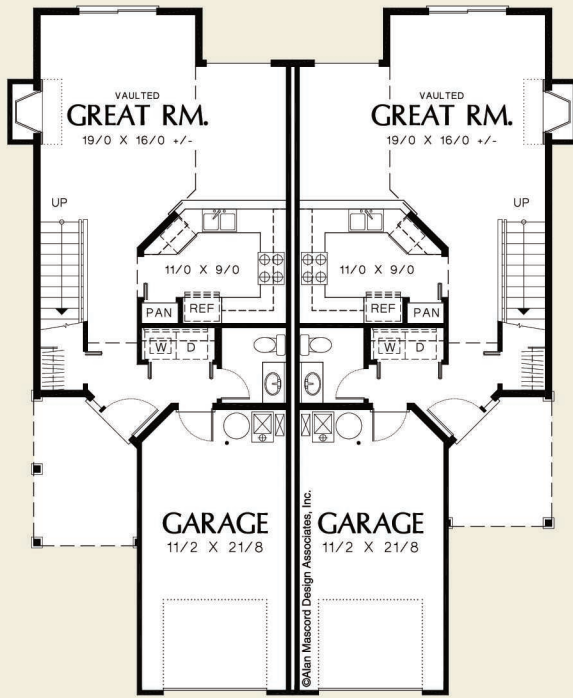

Upper Floor	601 Sq. Ft
Main Floor	596 Sq. Ft
Total Area	1197 Sq. Ft
Width	Depth
20'-0"	53'-0"
Height	(Main Flr to Peak): 26'-9"
	(to Midpt of Roof): 21'-4"



ALAN MASCORD DESIGN ASSOCIATES, INC
2187 NW Reed St, Suite 100, Portland, OR 97210 · 503.225.9161
mascord.com | houseplans.co