

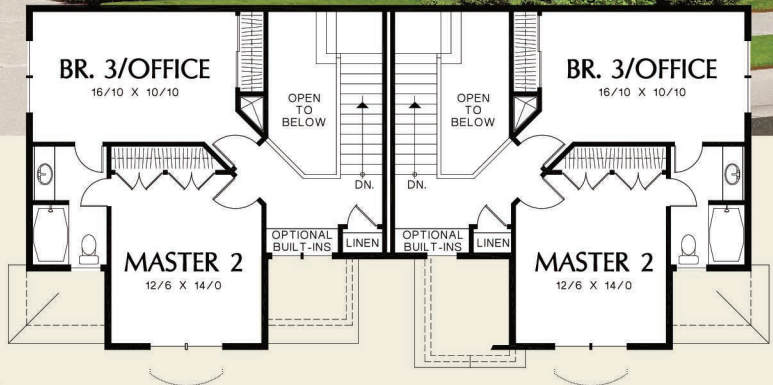

©Alan Mascord Design Associates, Inc.

©Alan Mascord Design Associates, Inc.



©Alan Mascord Design Associates, Inc.

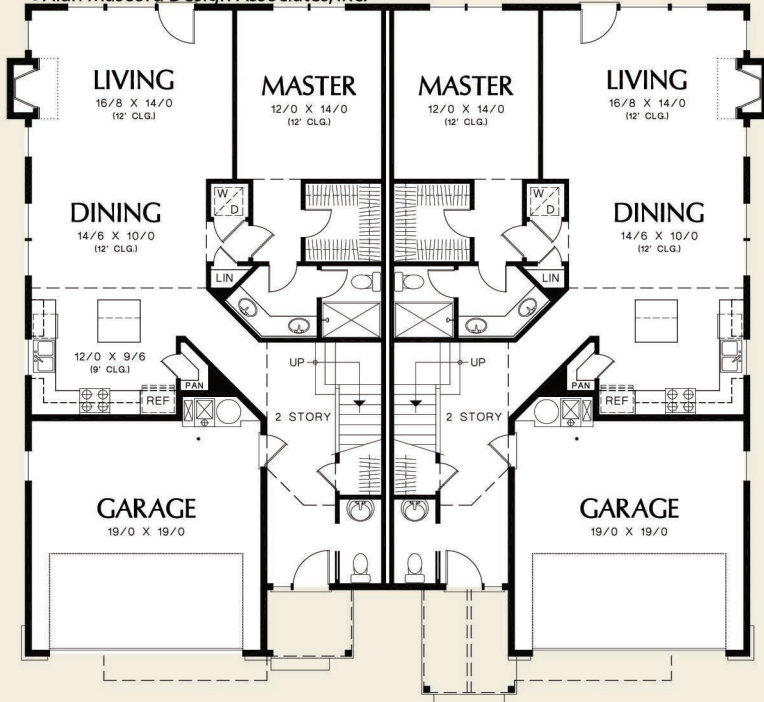

Upper Floor	601 Sq. Ft
Main Floor	1170 Sq. Ft
Total Area	1771 Sq. Ft
Width	Depth
30'-0"	57'-0"
Height	(Main Flr to Peak): 31'-3"
	(to Midpt of Roof): 25'-0"



ALAN MASCORD DESIGN ASSOCIATES, INC
2187 NW Reed St, Suite 100, Portland, OR 97210 · 503.225.9161

mascord.com | houseplans.co